



GAS COMPONENTS



ELECTRIC COMPONENTS



WATER TECHNOLOGY



MECHANICAL COMPONENTS



TOOLS

Spare parts suitable for

STAHL

Find the complete and up-to-date range of products in our GEV Webshop



Manufacturer catalogue

The most important spare parts and accessories arranged clearly for every manufacturer

- ✓ Complete product range and all appliance data always up to date in the GEV Webshop
- ✓ Alphabetical Index at the end of the catalogue

GEV Webshop

www.gev-online.co.uk

www.gev-online.com



- 🔍 Add to Favourites
- 🔍 Sign In with email address and usual password
- 🔍 Easy-order – place several items in your basket at the same time
- 🔍 Quick Item search – no login needed



heating elements

heating elements for bain maries

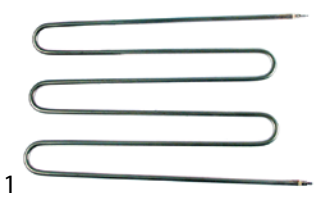

1

GEV No.	418280	Ref. No.	160031
description	heating element 1200W 230V heating circuits 1 L 410mm W 233mm connection M4 connection distance 225mm tube ø 8.5mm dry heating element bain marie		

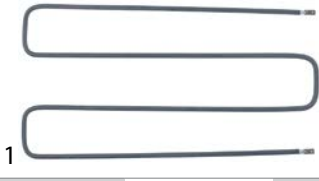





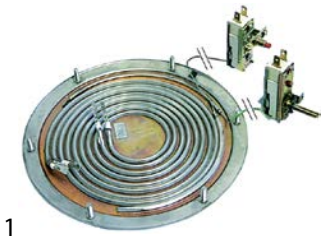

1

GEV No.	415545	Ref. No.	160025
description	heating element 855W 240V heating circuits 1 L 380mm L1 410mm W 204mm connection male faston 6.3mm connection distance 196mm tube ø 6.5mm dry heating element		

bottom heaters



1

GEV No.	415661	Ref. No.	160087	
description	bottom heater 3000W 230V heating circuits 2 ø 196mm safety thermostat 250°C thermostat 128°C M5 mounting distance 180mm			
spare parts for	415661			
	GEV No.	102067	Ref. No.	—
	nut thread M8x1 H 3mm brass Qty 1 pcs type SEF 1			
	GEV No.	375137	Ref. No.	—
	safety thermostat switch-off temp. 250°C 1-pole 16A probe ø 3.03mm probe L 160mm capillary pipe 880mm capillary pipe isolated 800mm gland nut probe SS with curved probe			
	GEV No.	375300	Ref. No.	—
	thermostat t.max. 128°C temperature range 35-128°C 1-pole 1NO 16A probe ø 3.1mm probe L 174mm capillary pipe 880mm capillary pipe isolated 800mm gland nut shaft L 23mm shaft position lower rotation 270°			
accessories for	415661			
	GEV No.	520323	Ref. No.	—
	gasket ID ø 160mm ED ø 200mm hole distance 90/180mm hole ø 7mm silicone for bottom heaters			
	GEV No.	520324	Ref. No.	—
	counterflange ID ø 160mm ED ø 200mm hole distance 90/180mm hole ø 7mm SS for bottom heaters			
	GEV No.	551083	Ref. No.	—
	cap for safety thermostat thread M8x1			

heating plates

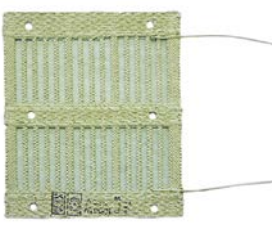

1



GEV No.	415734	Ref. No.	160055
description	heating grid 1000W 230V for heated cabinet heating circuits 1 L 220mm W 260mm		

ceramic heaters

245x60mm





1

GEV No.	415101	Ref. No.	160065	
description	ceramic emitter 250W 230V cable beaded cord L 245mm W 60mm H 35mm			
spare parts for	415101			
	GEV No.	415109	Ref. No.	—
	spring clip			
accessories for	415101			
	GEV No.	415110	Ref. No.	—
	reflector L 245mm W 95mm H 31mm thickness 0.75mm hole ø 15x40mm			



1

GEV No.	415102	Ref. No.	160070	
description	ceramic emitter 400W 230V cable beaded cord L 245mm W 60mm H 35mm			
spare parts for	415102			
	GEV No.	415109	Ref. No.	—
	spring clip			
accessories for	415102			
	GEV No.	415110	Ref. No.	—
	reflector L 245mm W 95mm H 31mm thickness 0.75mm hole ø 15x40mm			

accessories



GEV No.	550871	Ref. No.	160095
description	insulator female H 6mm hole ø 9.2mm ø 15mm		

energy regulators

EGO

1-circuit



GEV No.	380015	Ref. No.	167115
description	energy regulator 230V 13A single-circuit turn direction right shaft ø 6x4.6mm shaft L 23mm mounting thread M4 power release 6-100% no. 50.57021.010		

thermostats

control and safety thermostats

EGO

control thermostats

55.34_ series



GEV No.	375143	Ref. No.	162020
description	thermostat t.max. 110°C temperature range 32-110°C 3-pole 3NO 16A probe ø 6mm probe L 138mm capillary pipe 1480mm capillary pipe isolated 1100mm gland nut M9x1 shaft ø 6x4.6mm shaft L 23mm shaft position upper rotation 270°		



GEV No.	375019	Ref. No.	162015
description	thermostat t.max. 85°C temperature range 30-85°C 3-pole 3NO 16A probe ø 6mm probe L 131mm capillary pipe 1440mm capillary pipe isolatedmm gland nut M9x1 shaft ø 6x4.6mm shaft L 23mm shaft position upper rotation 270°		

control thermostats with operation switch

55.34_ series



GEV No.	375876	Ref. No.	162015
description	thermostat t.max. 85°C temperature range 30-85°C 3-pole 3NO 16A probe ø 6mm probe L 131mm capillary pipe 1440mm capillary pipe isolatedmm gland nut M9x1 shaft ø 6x4.6mm shaft L 23mm shaft position upper shaft position° rotation 270° outer switch 2NO with operation switch		

switches and momentary switches

cam switches

on/off



GEV No.	300020	Ref. No.	167100 A67100	
description	cam switch 4 operating positions 2NO sequence 0-1-0-1 16A shaft ø 6x4.6mm shaft L 23mm connection screw ceramic			
accessories for	300020			
	GEV No.	110135	Ref. No.	—
	rosette knob up to ø 52mm			
	GEV No.	110231	Ref. No.	—
	knob switch 0-1-0-1 t.max.°C°C ø 50mm shaft ø 6x4.6mm shaft flat upper black			

7-position



GEV No.	301233	Ref. No.	Nockenschalter 7-Tak
description	cam switch 7-position		

4 operating positions

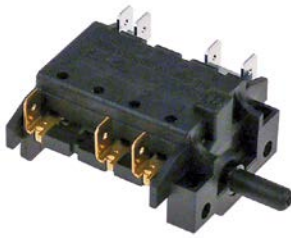

GEV No.	301199	Ref. No.	167105
description	cam switch 4 operating positions 3NO sequence 0-1-2-3 16A shaft ϕ 6x4.6mm shaft L 15mm connection male faston 6.3mm		

lamps

indicator lights

indicator lights (complete)

ϕ 14mm

with plug-in socket



GEV No.	359677	Ref. No.	168080
description	indicator light ϕ 14mm yellow 230V connection F2.8/F6.3		

linear lamps

infrared lamps

with base type R7s



GEV No.	359676	Ref. No.	160063 161030
description	infrared lamp socket R7s L 190mm 230V 350W IMPORT t.max. 500°C		

sockets for linear lamps

R7s



GEV No.	359717	Ref. No.	160063
description	lamp socket socket R7s 250V ϕ 18mm Lmm H 31mm connection cable 320mm mounting distance 28mm holder length 37mm cable material PTFE		

fans

hot air fans

ebm-papst



GEV No.	601249	Ref. No.	161030
description	hot air fan 230V 32W 0.27A L1 60mm L2 20mm L3 20mm L4 157mm fan wheel ϕ 150mm ebm-papst type R2K150-AC01-15		

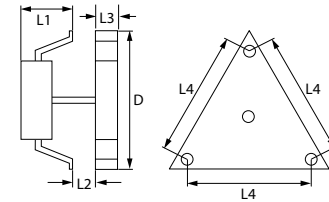

GEV No.	601013	Ref. No.	161.030
description	hot air fan 230V 43W 0.25A L1 60mm L2 20mm L3 25mm L4 155mm fan wheel ϕ 150mm type R2S150-AA08-29 ebm-papst 2200rpm		

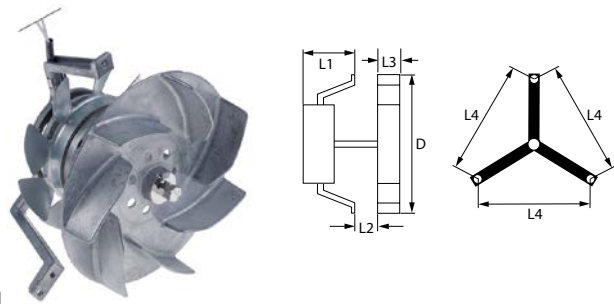

pullouts

drawer slides

producer-specific



GEV No.	692732	Ref. No.	1120.052
description	telescopic slide pair L 550mm pull-out length 590mm total length 1140mm Qty 1 pair capacity 50kg W 15mm H 60mm mounting pos. right/left SS telescopic		

GEV No.	691636	Ref. No.	120.056 FR 6010 580lg
description	telescopic slide pair L 580mm pull-out length 620mm Qty 1 pair capacity 50kg W 15mm H 60mm mounting pos. right/left SS telescopic L1 35mm L2 548mm		

B

bottom heaters 3

C

cam switches 4

ceramic heaters 3

control thermostats 4

E

energy regulators 4

F

fans 5

H

heating elements 3

heating elements for bain maries 3

heating plates 3

hot air fans 5

I

indicator lights 5

indicator lights (complete) 5

infrared lamps 5

L

lamps 5

linear lamps 5

S

switches and momentary switches 4

T

thermostats 4